

A307A - A307A

ATTACCHI SPECIFICI PER - SPECIFIC FITTING KIT FOR  
 KIT DE MONTAGE SPECIFIQUE POUR - SPEZIFISCHER MONTAGEKIT FÜR  
 ANCLAJE ESPECIFICO PARA

# HONDA SH 300i 2007

ISTRUZIONI DI MONTAGGIO - MOUNTING INSTRUCTIONS  
 INSTRUCCIONES DE MONTAJE - BAUANLEITUNG - INSTRUCIONES DE MONTAJE

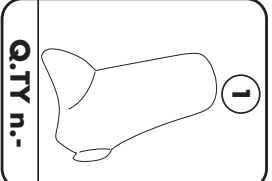
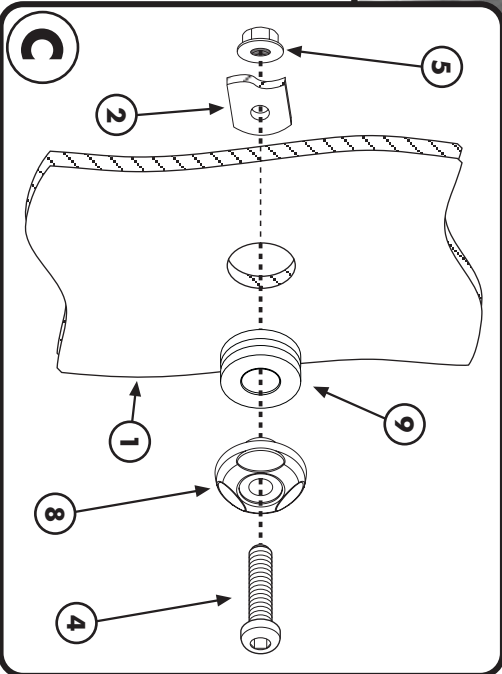
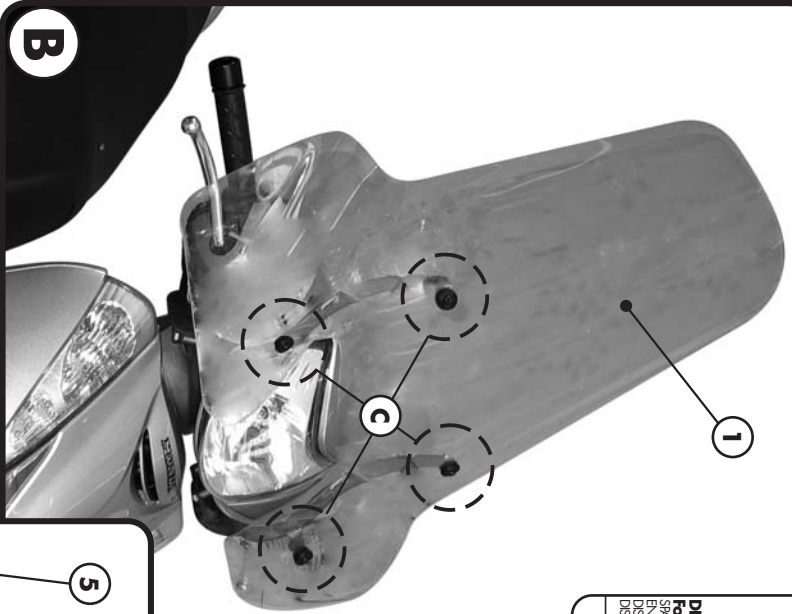
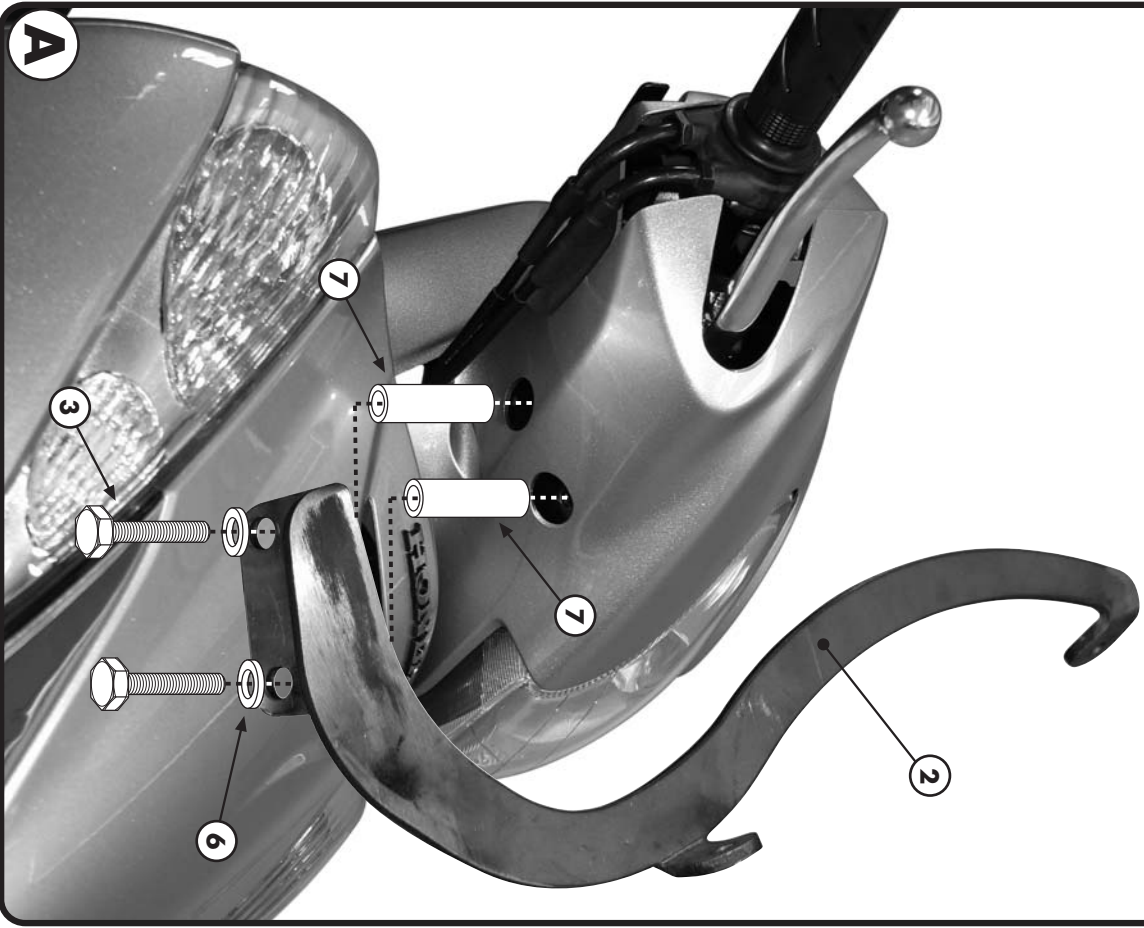

Q.TY n.-



Q.TY n.2 (Dx-Sx)

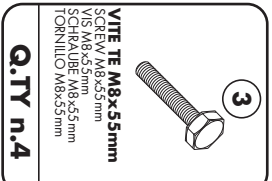

Q.TY n.4

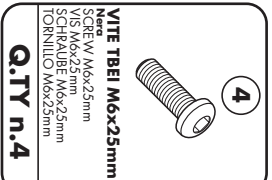

Q.TY n.4

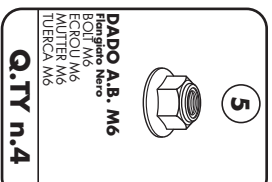

Q.TY n.4

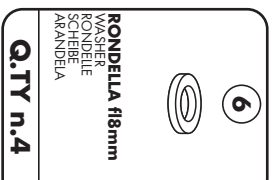

Q.TY n.4

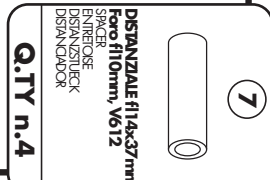

DISTANZIALE 11x4x37mm  
 SPACER  
 DISTANCE  
 DISTANZIERUNG  
 DESINADOR

Q.TY n.4



BUCCHIA DI RITENZIONE  
 ZB71N  
 PLASTIC BUSH  
 DISTANZIERUNG  
 PLASTIC BUSH  
 CASQUILLO

Q.TY n.4



GOMMINO Z268  
 FAREADER  
 CHAUVARD  
 GUMMI  
 GOMA

Q.TY n.4

ATTACCHI SPECIFICI PER - SPECIFIC FITTING KIT FOR  
KIT DE MONTAGE SPECIFIQUE POUR - SPEZIFISCHER MONTAGEKIT F R  
ANCLAE ESPECIFICO PARA

# HONDA SH 300i 2007

ISTRUZIONI DI MONTAGGIO - MOUNTING INSTRUCTIONS  
INSTRUCTIONS DE MONTAGE - BAUANLEITUNG - INSTRUCCIONES DE MONTAJE

## I ISTRUZIONI DI MONTAGGIO

1. MONTARE I SUPPORTI N°2 COME INDICATO IN FOTOGRAFIA A;
2. MONTARE IL PARABREZZA (NON INCLUSO) COME INDICATO IN FOTOGRAFIA B FACENDO RIFERIMENTO ALL'IMMAGINE C;
3. ULTIMARE IL MONTAGGIO CONTROLLANDO CHE LE VITI SIANO SERRATE BENE.

## GB MOUNTING INSTRUCTIONS

1. MOUNT THE SUPPORTS N° 2 AS SHOWN IN PICTURE A;
2. MOUNT THE WINDSCREEN (NOT INCLUDED) AS SHOWN IN PICTURE B AND ALSO MAKING REFERENCE TO PICTURE C;
3. LASTLY CHECK THAT ALL SCREWS HAVE BEEN TIGHTENED.

## F INSTRUCTIONS DE MONTAGE

1. DEMONTER LES SUPPORTS N.2 COMME INDIQUE EN PHOTO A;
2. MONTER LE PARE-BRISE (PAS INCLUS) COMME INDIQUE EN PHOTO B EN SE REFERANT A L'IMMAGE C ;
3. TERMINER LE MONTEGE EN CONTROLANT LE BON SERRAGE DE TOUTES LES VIS.

## D BAUANLEITUNG

1. MONTEREN SIE DIE HALTERUNGEN NR. 2 WIE IM BILD A BESCHRIEBEN;
2. MONTEREN SIE DAS WINDSCHILD (NICHT VORHANDEN) WIE IM BILD A BESCHRIEBEN UND NEHMEN SIE BEZUG AUF BILD C;
3. ZULETZT ÜBERPRÜFEN SIE, DASS ALLE SCHRAUBEN FESTGEZOGEN WÜRDEN.

## ES

## INSTRUCCIONES DE MONTAJE

1. MONTAR LOS SUPORTES COMO INDICADO EN LA FOTOGRAFIA "A";
2. MONTAR EL PARABRISAS (NO INCLUIDO) COMO EN LA FOTOGRAFIA "B", HACER REFERENCIA A LA IMAGEN "C";
3. FINALIZAR EL MONTAJE ASEGURANDOSE DE QUE TODOS LOS TORNILLOS ESTEN BIEN APRETADOS.